

Heritage Village

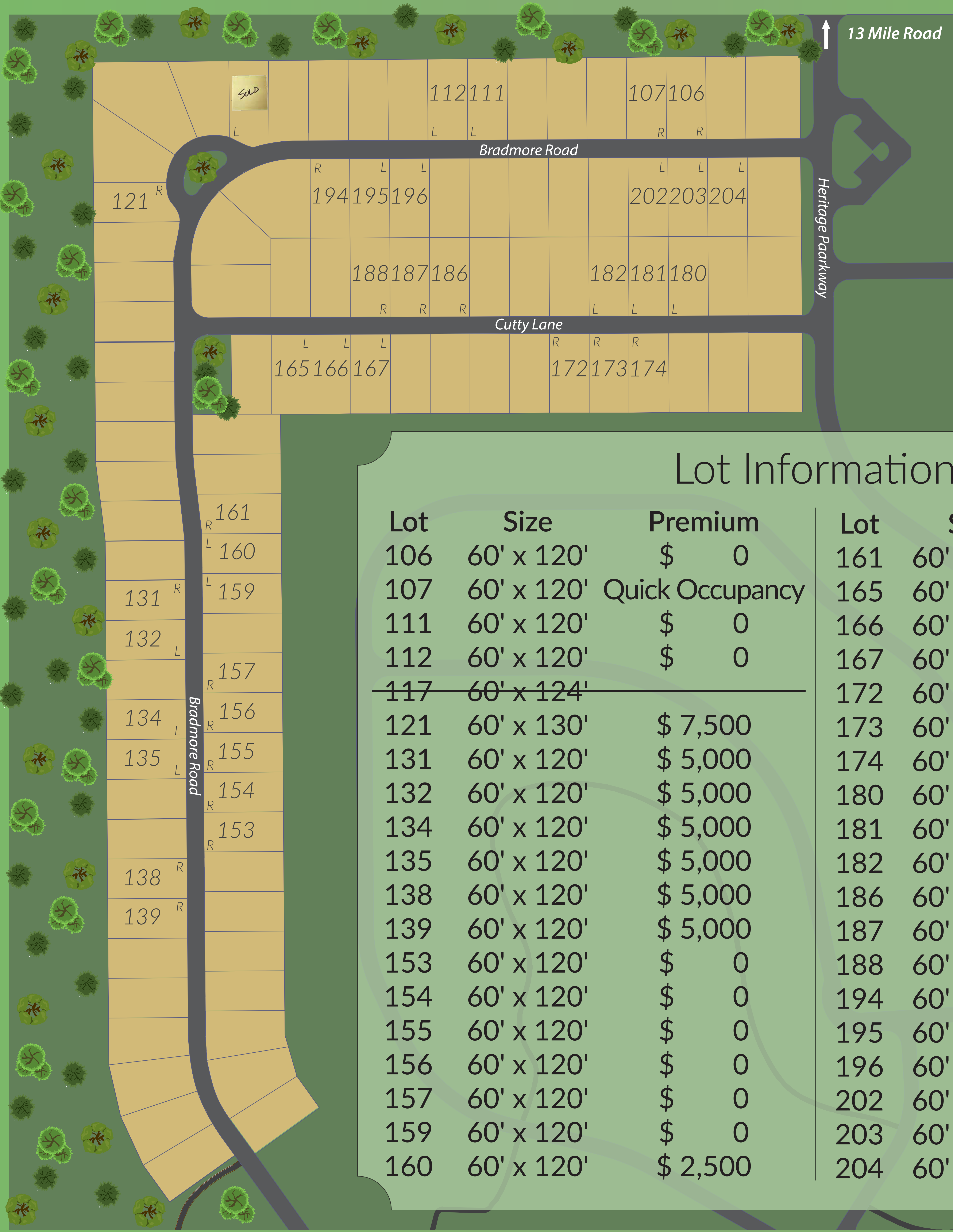

Lot Information

| Lot | Size | Premium | Lot | Size | Premium |
|----------------|-----------------------|-----------------|-----|------------|-----------------|
| 106 | 60' x 120' | \$ 0 | 161 | 60' x 127' | \$ 4,000 |
| 107 | 60' x 120' | Quick Occupancy | 165 | 60' x 120' | Quick Occupancy |
| 111 | 60' x 120' | \$ 0 | 166 | 60' x 120' | \$ 5,000 |
| 112 | 60' x 120' | \$ 0 | 167 | 60' x 120' | \$ 2,500 |
| 117 | 60' x 124' | | 172 | 60' x 120' | \$ 0 |
| 121 | 60' x 130' | \$ 7,500 | 173 | 60' x 120' | \$ 0 |
| 131 | 60' x 120' | \$ 5,000 | 174 | 60' x 120' | \$ 0 |
| 132 | 60' x 120' | \$ 5,000 | 180 | 60' x 120' | \$ 0 |
| 134 | 60' x 120' | \$ 5,000 | 181 | 60' x 120' | \$ 0 |
| 135 | 60' x 120' | \$ 5,000 | 182 | 60' x 120' | Quick Occupancy |
| 138 | 60' x 120' | \$ 5,000 | 186 | 60' x 120' | \$ 0 |
| 139 | 60' x 120' | \$ 5,000 | 187 | 60' x 120' | \$ 0 |
| 153 | 60' x 120' | \$ 0 | 188 | 60' x 120' | \$ 0 |
| 154 | 60' x 120' | \$ 0 | 194 | 60' x 120' | \$ 0 |
| 155 | 60' x 120' | \$ 0 | 195 | 60' x 120' | \$ 0 |
| 156 | 60' x 120' | \$ 0 | 196 | 60' x 120' | \$ 0 |
| 157 | 60' x 120' | \$ 0 | 202 | 60' x 120' | Quick Occupancy |
| 159 | 60' x 120' | \$ 0 | 203 | 60' x 120' | \$ 0 |
| 160 | 60' x 120' | \$ 2,500 | 204 | 60' x 120' | \$ 0 |

Quick Occupancy

| Lot | Plan | Price |
|-----|-------|-----------|
| 107 | Dover | \$289,900 |
| 165 | Dover | \$309,900 |
| 182 | Dover | \$289,900 |
| 202 | Dover | \$299,900 |



Master Association Fee: \$250/year • Projected Homeowner Association Fee: \$850/year